

## R-MNL-W Hardened nails with washer

Hardened nails for masonry and heavy duty applications

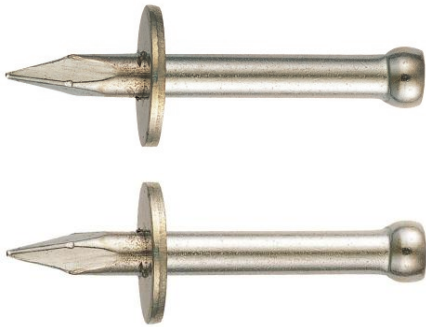

### Product information

#### Features and benefits

- Made of low carbon hardened steel wire
- Solid head providing rigid striking surface
- Long diamond shaped sharp point for easy drive in of the nail
- Available in version with washer for greater pull-through resistance

#### Applications

- Fixing elements to the concrete base
- Exotic wood and dense material constructions
- Anchoring of wood connection elements
- Wooden roof constructions
- Framing applications
- Wooden fences
- Pergolas, bowers, sheds

#### Base materials

##### Approved for use in:

- Concrete
- Hollow Brick
- Hollow Sand-lime Brick
- Wood
- Timber
- Timber

### Installation guide

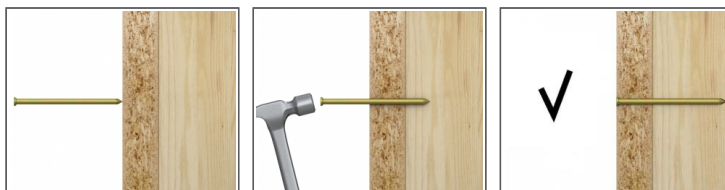

1. Choose the appropriate dimension and length of the nail
2. Set the fastened element in required place and position
3. Hammer in the nail until the head is flush
4. Use the necessary quantity of nails to fasten the element secure

**Product information**

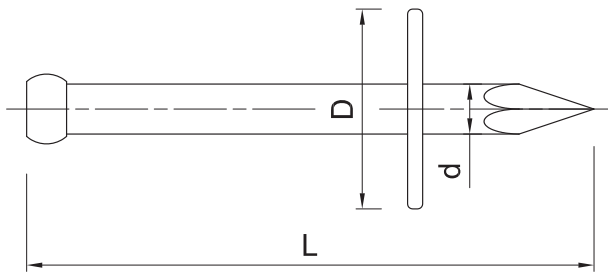

Product Code	Nail	
	Diameter	Length
	d	L
	[mm]	[mm]
R-MNL-W-37030	3.7	30
R-MNL-W-37040	3.7	40
R-MNL-W-37050	3.7	50
R-MNL-W-37025	3.7	25
R-MNL-W-37035	3.7	35

**Product commercial data**

Product Code	Nail		Quantity [pcs]			Weight [kg]			Bar Codes
	Diameter [mm]	Length [mm]	Box	Outer	Pallet	Box	Outer	Pallet	
R-MNL-W-37030	3.7	30	100	100	200000	0.40	0.40	830.0	5010445040467
R-MNL-W-37040	3.7	40	100	100	200000	0.40	0.40	830.0	5010445040504
R-MNL-W-37050	3.7	50	100	100	200000	0.40	0.40	830.0	5010445040528
R-MNL-W-37025	3.7	25	100	100	200000	0.40	0.40	838.0	5010445040443
R-MNL-W-37035	3.7	35							