

## O Metal frame anchor

Metal frame anchor for window and door installation

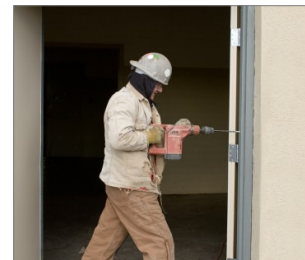

### Product information

#### Features and benefits

- Metal sleeve design guards against distortion of the frame
- Anti-rotation lugs prevent rotation during tightening
- All-steel construction for strength and durability
- Quick and easy installation.
- The cover caps (available separately) can be used to discreetly cover the head of anchor.

#### Applications

- Door and window frames

#### Base materials

Approved for use in:

- Concrete
- Reinforced concrete

### Installation guide

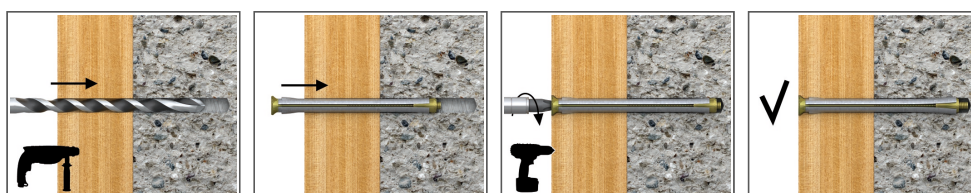

1. Drill a hole of required diameter and depth
2. Lightly tap the anchor through the fixture into hole with hammer, until fixing depth is reached
3. Tighten screw until secure

## Product information

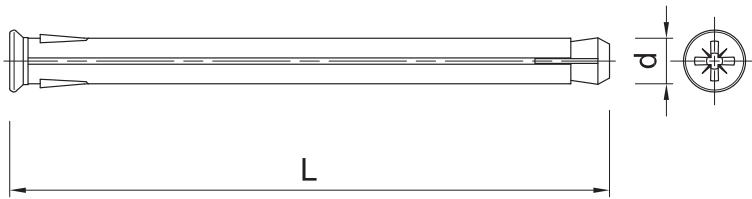

Size	Product Code	Anchor		Fixture		
		Diameter	Length	Max. thickness		Hole diameter
		d	L	t <sub>fix</sub> Concrete	t <sub>fix</sub> Solid brick	d <sub>f</sub>
[mm]						
M10	O-10072	10	72	32	12	11
	O-10092	10	92	52	32	11
	O-10112	10	112	72	52	11
	O-10132	10	132	92	72	11
	O-10152	10	152	112	92	11
	O-10182	10	182	142	122	11
	O-10202	10	202	162	142	11
	R-O-10072	10	72	32	12	11
	R-O-10092	10	92	52	32	11
	R-O-10112	10	112	72	52	11
	R-O-10132	10	132	92	72	11
	R-O-10152	10	152	112	92	11
	R-O-10182	10	182	142	122	11
	R-O-10202	10	202	162	142	11

## Installation data

Substrate			Concrete	Solid brick
Hole diameter in substrate	d <sub>0</sub>	[mm]	10	10
Min. hole depth in substrate	h <sub>0</sub>	[mm]	50	70
Min. installation depth	h <sub>nom</sub>	[mm]	40	60
Min. substrate thickness	h <sub>min</sub>	[mm]	70	90
Min. spacing	s <sub>min</sub>	[mm]	40	40
Min. edge distance	c <sub>min</sub>	[mm]	60	60
Diameter	d	[mm]	10	10

## Basic performance data

Performance data for single fixing without influence of edge distance and spacing

Substrate		Concrete C20/25	Solid brick 7.5MPa
<b>MEAN ULTIMATE LOAD F<sub>R0,m</sub></b>			
M10, Effective embedment depth 40 mm	[kN]	9.19	-
M10, Effective embedment depth 60 mm	[kN]	-	4.35
<b>CHARACTERISTIC LOAD F<sub>Rk</sub></b>			
M10, Effective embedment depth 40 mm	[kN]	5.50	-
M10, Effective embedment depth 60 mm	[kN]	-	2.50
<b>DESIGN LOAD F<sub>Rd</sub></b>			
M10, Effective embedment depth 40 mm	[kN]	2.20	-
M10, Effective embedment depth 60 mm	[kN]	-	0.90
<b>RECOMMENDED LOAD F<sub>rec</sub></b>			
M10, Effective embedment depth 40 mm	[kN]	1.57	-
M10, Effective embedment depth 60 mm	[kN]	-	0.64

## Product commercial data

Product Code	Anchor		Quantity [pcs]			Weight [kg]			Bar Codes
	Diameter [mm]	Length [mm]	Box	Outer	Pallet	Box	Outer	Pallet	
O-10072	10	72	100	600	27000	2.8	16.9	791.4	5906675091129
O-10092	10	92	100	600	19200	3.5	21.0	701.5	5906675091228
O-10112	10	112	100	400	24000	4.0	16.1	994.8	5906675091327
O-10132	10	132	100	400	7300	4.7	18.7	370.8	5906675091426
O-10152	10	152	100	400	16000	5.3	21.2	877.7	5906675091525
O-10182	10	182	100	300	10800	6.2	18.5	696.8	5906675091624
O-10202	10	202	100	300	11500	6.8	20.4	811.3	5906675091723
R-O-10072	10	72	100	1200	28800	1.59	19.1	487.9	5010445211003
R-O-10092	10	92	100	100	36400	2.0	2.0	739.8	5010445211010
R-O-10112	10	112	100	100	36400	2.3	2.3	859.9	5010445211027
R-O-10132	10	132	100	100	16800	2.6	2.6	471.8	5010445211041
R-O-10152	10	152	100	100	22400	6.0	6.0	1367.3	5010445211065
R-O-10182	10	182	100	100	15600	7.0	7.0	1117.3	5010445211089
R-O-10202	10	202	100	100	36400	7.7	7.7	2829.2	5906675172064