

## FT for wood

Coarse thread screws for fixing plasterboards to wooden framing

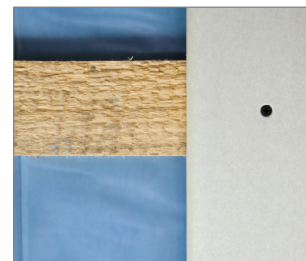

### Approvals and Reports

PN-EN 14566 + A1: 2012

DoP-EN14566

Reaction to fire: A1

Flexural strength: pass

CE  
10

### Product information

#### Features and benefits

- Optimised screw tip geometry - excellent drilling capability
- No pre-drilling required
- Low-carbon steel with black phosphate finish for increased durability
- Bugle head with PH2 drive designed to finish flush with plasterboard

#### Applications

- Fastening plasterboard walls to wooden framework

#### Base materials

**Approved for use in:**

- Wood

### Installation guide

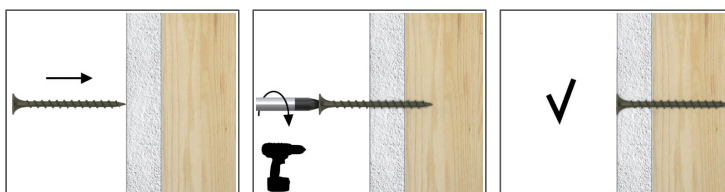

1. Drive the screw straight until the head is flush
2. Screws with countersunk head allow flush connection

## Product information

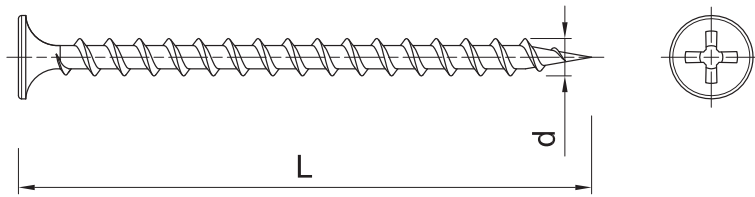

Size	Product Code	Screw		Fixture
		Diameter	Length	Max. thickness
		d	L	t <sub>fix</sub>
		[mm]	[mm]	[mm]
Ø3.5	FT-3525	3.5	25	8
	FT-3535	3.5	35	18
	FT-3545	3.5	45	28
	FT-3555	3.5	55	38
Ø4.2	FT-4270	4.2	70	49
Ø4.8	FT-4890	4.8	90	67
	FT-48100	4.8	100	77
	FT-48110	4.8	110	87
	FT-48120	4.8	120	97
Ø3.5	FTK-3525	3.5	25	8
	FTK-3535	3.5	35	8
	FTK-3545	3.5	45	8
	FTK-3555	3.5	55	8
	FTK-4270	4.2	70	8
	FTK-4890	4.8	90	8

## Installation data

Size			Ø3.5	Ø4.2	Ø4.8
Substrate			Timber	Timber	Timber
Min. installation depth	h <sub>nom</sub>	[mm]	14	17	19
Min. substrate thickness	h <sub>min</sub>	[mm]	28	34	38
Min. spacing	s <sub>min</sub>	[mm]	30	30	30
Min. edge distance	c <sub>min</sub>	[mm]	30	30	30

## Basic performance data

Performance data for single screw without influence of edge distance and spacing

Size			Ø3.5	Ø4.2	Ø4.8
Substrate			Steel	Steel	Steel
Substrate thickness h <sub>min</sub>	[mm]		0.5	0.5	0.5
<b>CHARACTERISTIC LOAD F<sub>Rk</sub></b>					
FT F <sub>Rk</sub>	-		0.55	0.55	0.55
<b>DESIGN LOAD F<sub>Rd</sub></b>					
FT F <sub>Rd</sub>	-		0.29	0.29	0.29
<b>RECOMMENDED LOAD F<sub>REC</sub></b>					
FT F <sub>rec</sub>	-		0.21	0.21	0.21

## Product commercial data

Product Code	Screw	Quantity [pcs]			Weight [kg]			Bar Codes
	Length [mm]	Box	Outer	Pallet	Box	Outer	Pallet	
FT-3525	25	1000.0	16000.0	384000.0	1.39	22.3	564.5	5906675300122
FT-3535	35	1000.0	12000.0	288000.0	1.69	20.3	517.6	5906675300221
FT-3545	45	500.0	6000.0	144000.0	1.09	13.0	342.5	5906675300320
FT-3555	55	500.0	6000.0	144000.0	1.29	15.5	402.7	5906675300429
FT-4270	70	250.0	3000.0	72000.0	1.18	14.1	369.3	5906675301020
FT-4890	90	250.0	3000.0	72000.0	1.93	23.2	586.4	5906675301129
FT-48100	100	200.0	2400.0	57600.0	1.77	21.2	539.8	5906675301228
FT-48110	110	200.0	2400.0	57600.0	1.82	21.8	554.2	5906675301327
FT-48120	120	200.0	2400.0	57600.0	1.93	23.1	585.0	5906675301426
FTK-3525	25	10.0	10.0	-	10.4	10.4	403.3	5906675193083
FTK-3535	35	10.0	10.0	-	10.4	10.4	527.1	5906675193090
FTK-3545	45	10.0	10.0	-	10.4	10.4	403.7	5906675193106
FTK-3555	55	10.0	10.0	-	10.4	10.4	403.2	5906675193113
FTK-4270	70	10.0	10.0	-	10.5	10.5	406.6	5906675193137
FTK-4890	90	10.0	10.0	-	10.5	10.5	407.5	5906675193144