

## WHO Frame screw

Special frame screw for window and door installation



### Product information

#### Features and benefits

- Flat head for flush installation with the window and door frames.
- Expansion-free fixing imposes less stress on substrate during installation
- High load resistances from a relatively small hole diameter
- Easily removed for temporary works

#### Applications

- Door and window frames
- Securing formwork
- Suspended ceilings
- Lightweight steel angles
- Timber constructions

#### Base materials

##### Approved for use in:

- Concrete
- Solid Brick
- Hollow Brick
- Aerated Concrete Block

### Installation guide

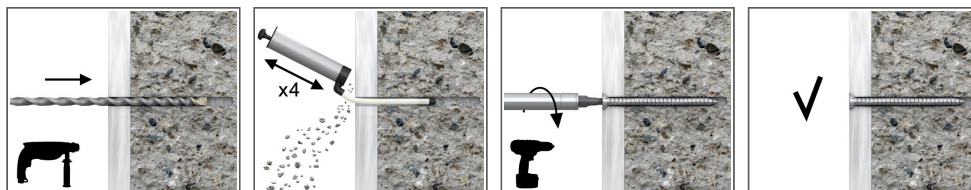

1. Drill a hole of required diameter and depth
2. Lightly screw into hole through the fixture, until fixing depth is reached and fixture is secure

## Product information

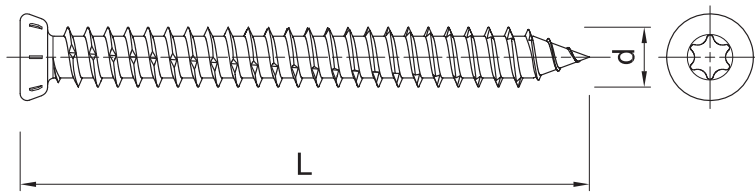

Size	Product Code	Screw		Fixture		
		Diameter	Length	Max. thickness		Hole diameter
		d	L	t <sub>fix</sub> Concrete	t <sub>fix</sub> Other	d <sub>f</sub>
[mm]						
Ø7.5	R-WHO-75052	7.5	52	22	-	8
	R-WHO-75072	7.5	72	42	12	8
	R-WHO-75092	7.5	92	62	32	8
	R-WHO-75112	7.5	112	82	52	8
	R-WHO-75132	7.5	132	102	72	8
	R-WHO-75152	7.5	152	122	92	8
	R-WHO-75182	7.5	182	152	122	8
	R-WHO-75202	7.5	202	172	142	8
	R-WHO-75212	7.5	212	182	152	8

## Installation data

Substrate			Concrete	Aerated concrete	Other
Hole diameter in substrate	d <sub>0</sub>	[mm]	6	6	6
Min. hole depth in substrate	h <sub>0</sub>	[mm]	40	-	70
Min. installation depth	h <sub>nom</sub>	[mm]	30	60	60
Min. substrate thickness	h <sub>min</sub>	[mm]	60	90	90
Min. spacing	s <sub>min</sub>	[mm]	15	30	30
Min. edge distance	c <sub>min</sub>	[mm]	15	50	50
Fixing diameter	d	[mm]	7.5	7.5	7.5

## Basic performance data

Performance data for single fixing without influence of edge distance and spacing

Substrate		Concrete C20/25	Solid brick 7.5MPa	Aerated concrete 400	Perforated brick K3
<b>MEAN ULTIMATE LOAD F<sub>Ru,m</sub></b>					
Ø7.5, Effective embedment depth 30 mm	[kN]	6.15	-	-	-
Ø7.5, Effective embedment depth 60 mm	[kN]	-	2.58	1.27	1.02
<b>CHARACTERISTIC LOAD F<sub>Rk</sub></b>					
Ø7.5, Effective embedment depth 30 mm	[kN]	5.21	-	-	-
Ø7.5, Effective embedment depth 60 mm	[kN]	-	2.11	1.14	0.90
<b>DESIGN LOAD F<sub>Rd</sub></b>					
Ø7.5, Effective embedment depth 30 mm	[kN]	2.08	-	-	-
Ø7.5, Effective embedment depth 60 mm	[kN]	-	0.84	0.46	0.36
<b>RECOMMENDED LOAD F<sub>rec</sub></b>					
Ø7.5, Effective embedment depth 30 mm	[kN]	1.49	-	-	-
Ø7.5, Effective embedment depth 60 mm	[kN]	-	0.60	0.33	0.26

### Product commercial data

Product Code	Screw	Quantity [pcs]			Weight [kg]			Bar Codes
	Length [mm]	Box	Outer	Pallet	Box	Outer	Pallet	
R-WHO-75052	52	100	1600	38400	1.04	16.7	429.7	5906675174648
R-WHO-75072	72	100	1600	38400	1.45	23.2	586.0	5906675174662
R-WHO-75092	92	100	100	19200	1.89	1.89	392.7	5906675174686
R-WHO-75112	112	100	100	19200	2.3	2.3	470.8	5906675174709
R-WHO-75132	132	100	100	19200	2.7	2.7	551.7	5906675174723
R-WHO-75152	152	100	100	19200	3.1	3.1	630.2	5906675174747
R-WHO-75182	182	100	100	27300	3.7	3.7	1048.3	5906675174761
R-WHO-75202	202	100	100	27300	4.2	4.2	1161.6	5906675174785
R-WHO-75212	212	100	100	27300	4.3	4.3	1206.1	5906675174808